

Elkington Close



Significantly upgraded and re-modelled

Impressive refitted kitchen/diner

Stylish and impressive throughout

Superb refitted family bathroom

Five bedrooms, two bathrooms



Multi-Award Wining



Superb! This impressive property has been significantly re-modelled and upgraded by the current owners, and internal inspection is highly recommended to fully appreciate the quality and space on offer.

The stylish accommodation is delivered across three levels, with off road parking to the front, and an enclosed rear garden. The outstanding family bathroom, refitted kitchen and generous room sizes throughout, are all stand out features. Very briefly, the accommodation comprises an entrance hall, lounge with feature 'Split Face' tiled wall and built in fire, separate spacious kitchen/diner and utility with cloakroom/WC incorporated to the ground floor. The first floor delivers two bedrooms, one formally being the living room and could easily be optimised as another living space to suit any new owner, being especially generous with 'French' doors to the rear 'Juliet' balcony. You will also find the outstanding family bathroom on this level, with four piece suite including 'free standing' bath. The second floor brings three more bedrooms, two with robes and one with modern en-suite.

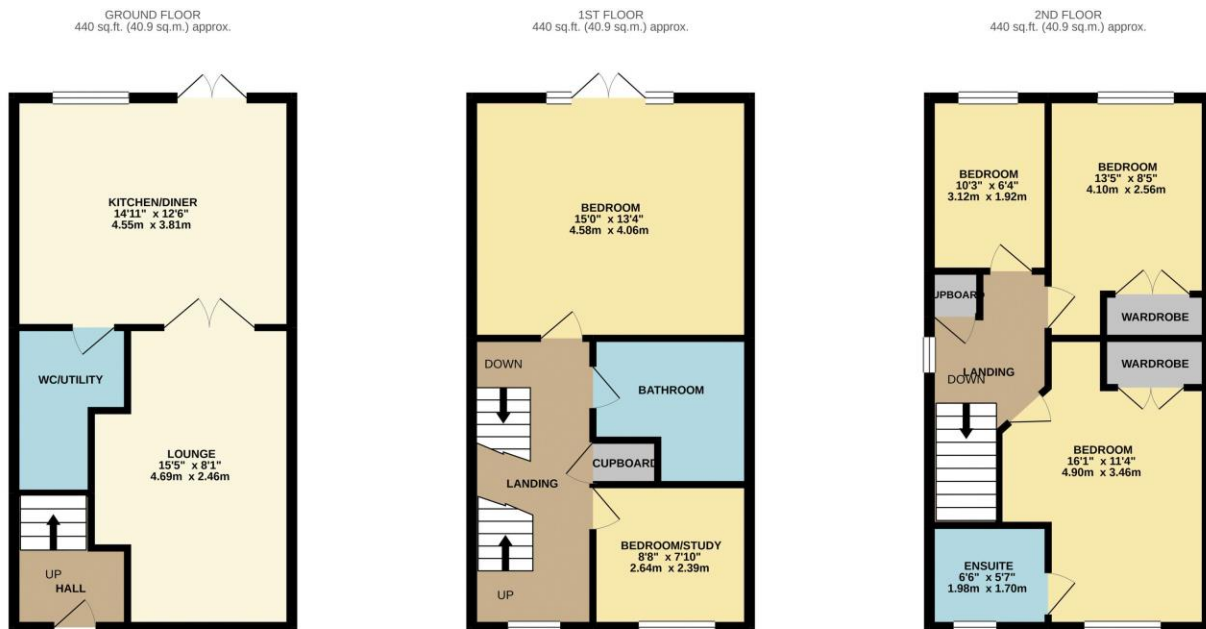

TOTAL FLOOR AREA: 1320 sq.ft. (122.6 sq.m.) approx.

Whilst every attempt has been made to ensure the accuracy of the floorplan contained here, measurements of doors, windows, rooms and any other items are approximate and no responsibility is taken for any error, omission or mis-statement. This plan is for illustrative purposes only and should be used as such by any prospective purchaser. The services, systems and appliances shown have not been tested and no guarantee as to their operability or efficiency can be given.

Made with Metropix ©2021



"The Property Experts"



AGENTS NOTE: Every care has been taken with the preparation of these details, but they are for general guidance only. Measurements and dimensions are approximate, and any fixtures or fittings shown in photography does not infer that they are to be included within the sale. The agent has not tested any appliances or supplies and professional verification of these should be sought prior to purchase if required. These particulars do not constitute a contract or part of a contract.